

### INTRODUCTION

Model	Description
I69-100 / 200 / 210	95W UPoE output

### PACKAGE CONTENTS

* 1x PoE injector	* 1x DIN rail bracket	* 1x 2-pin terminal block
* 1x Quick Installation Guide		

### ⚠ IMPORTANT:

1. Use CAT5 or 5e UTP/STP cables.
2. Always shut down the power source before connecting power wires.
3. DC input (48-56VDC). Follow the printed polarity for V+, V-, and Ground.

### CONNECTION

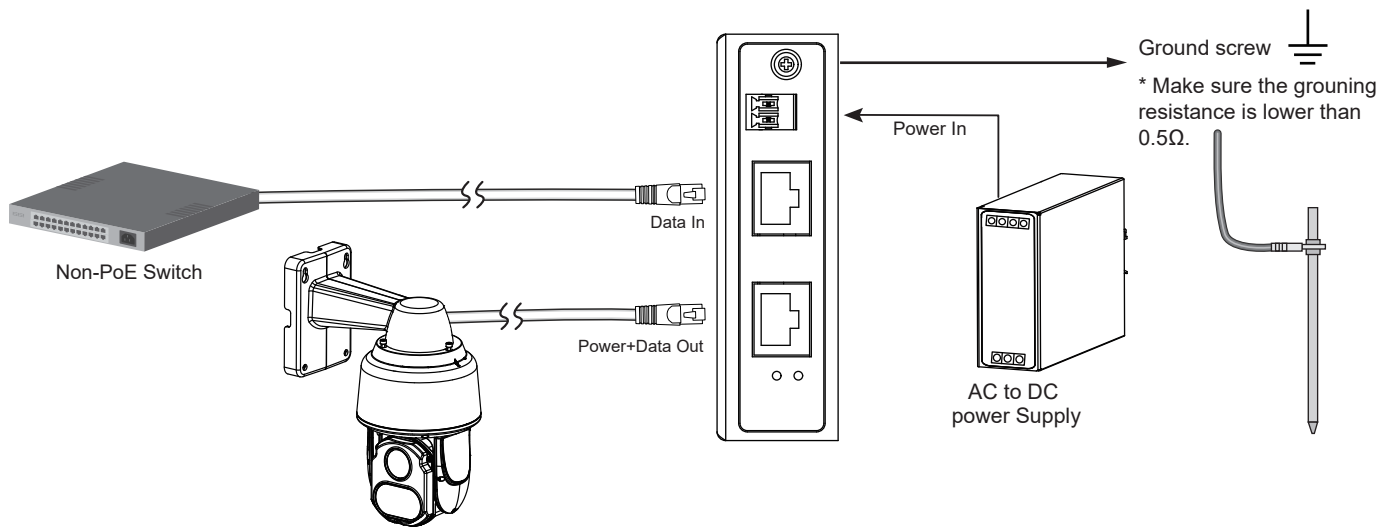

### LEDs

#### LED definitions:

Power	Green ON: power good; OFF: power failed.
PoE	Amber ON: PD detected

### I69-100

