

### INTRODUCTION

Model	Description
SD-504	4-ch Modular 1G/2.5G Smart IP PoE surge protector
SD-524	24-ch Modular 1G/2.5G Smart IP PoE surge protector
SD-501-M	1-ch Smart IP PoE surge Modular for replacement
SD-524-C	Smart IP 19", 1U 24-ch chassis

### PACKAGE CONTENTS

* 1x surge protector	* 1x Quick Installation Guide
----------------------	-------------------------------

### IMPORTANT:

1. Use CAT5e or CAT6 UTP/STP cables.
2. The cabling distance between the surge protector and the protected device should be less than 1 meter.

### CONNECTION

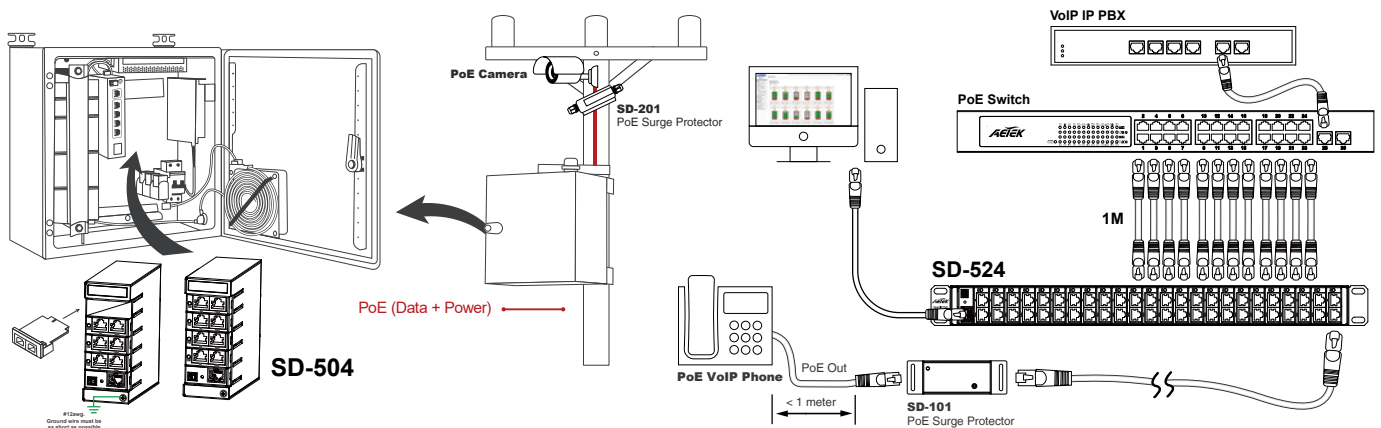

### DEFAULTS

IP Address	DHCP client
------------	-------------

Account / Password

The device contains a security feature that requires a user to generate a new means of authentication before access is granted to the device for the first time.

Username

New password

New password confirm

The first time login need key in new username and password, please enter the new username and password, and then click the <Apply> button.

### LEDs

IP Module	LAN	Green flash	Data is being transmitted or received.
		OFF	No connection.
	SYS	Yellow	ON: System is ready, Power is supplied.
Surge Module	Fail	Red	ON: Out of service life.

### Reset Button

Reset to default	15 seconds
------------------	------------

All specifications are subject to change without notice.  
Copyright © 2020 AETEK INC. All rights reserved.

